



Strategies to keep people and goods moving in and through Seattle

The Seattle Squeeze and the SR 99 closure
2018-2024

Seattle Pedestrian Advisory Board
December 14, 2018

Meghan Shepard, SDOT



City of Seattle



How we get around is about to change

Over the next five years private and public construction projects will continue to change how we move and deliver goods

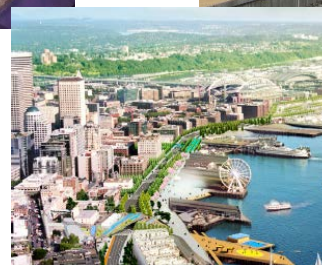

Where we are headed



Pike Pine Renaissance



Central Waterfront



WA State Convention Center



Key Arena



Growing light rail system



Our five strategies for downtown mobility



Monitoring and managing our transportation system



Reducing the number of drive-alone trips downtown



Investing in transit and expanding access



Managing the public right-of-way



Communicating with the public



Steps remaining to open the SR 99 tunnel

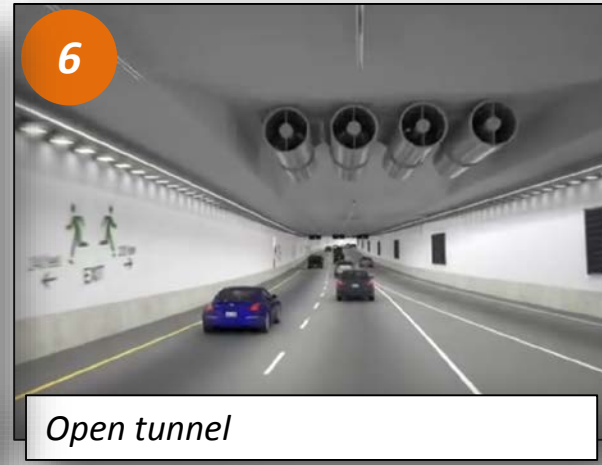

SR 99 closure and tunnel opening: get ready

Scheduled to begin January 11, 2019

- **Duration:** about three-weeks for SR 99 closure and up to three weeks of ramp closures
- **Closing a highway adds more drivers to other parts of the system:** 90,000 vehicles per day, including several thousand trucks, and buses have to use another route
- **Expect long backups:** On I-5 and routes into downtown Seattle, especially during peak commute times
- **Major change to transportation system:** New SR 99 tunnel will open, other construction continues

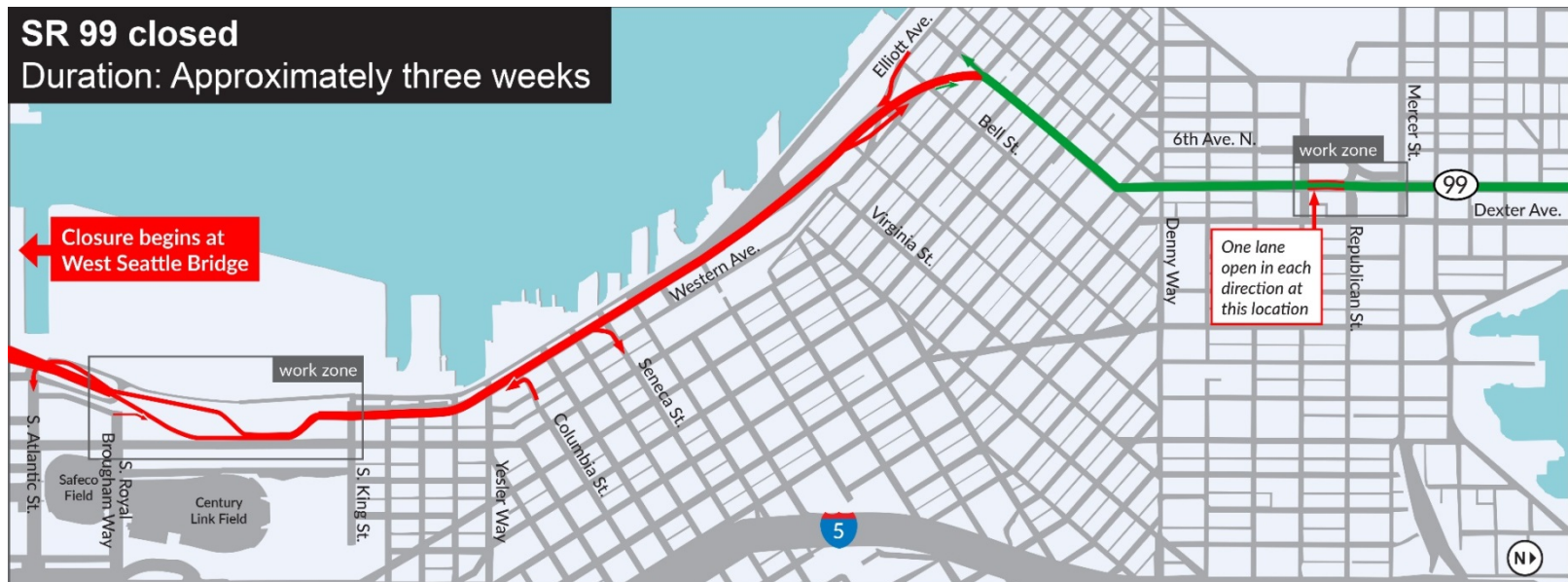

2016 SR 99 closure

Travel time: Bellevue to Seattle (I-90 westbound)

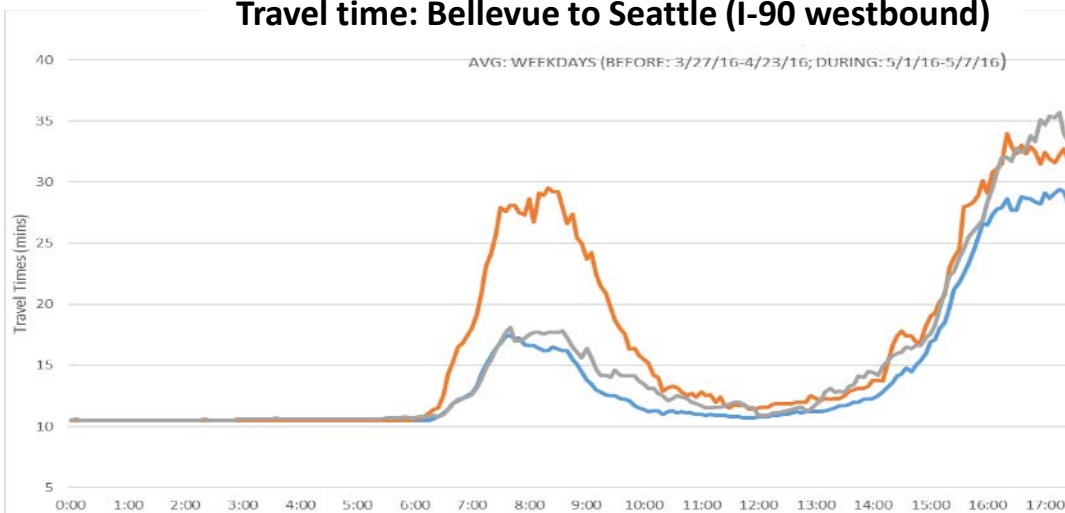

Travel time: Federal Way to Seattle (I-5 northbound)

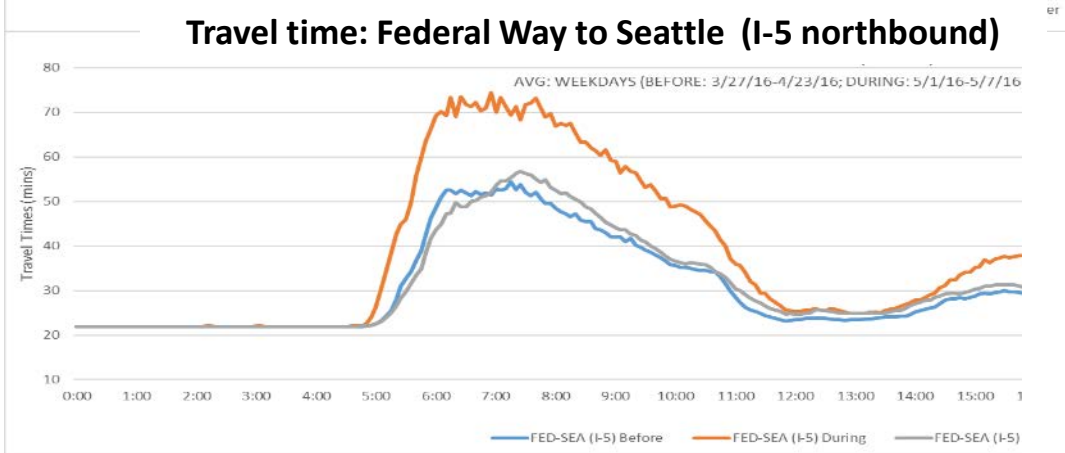

What we experienced during nine-day SR 99 closure in 2016

- Region-wide impacts: higher travel times on I-5, SR 520, I-90
- Peak commutes started earlier and lasted longer
- More vehicles on downtown streets
- Sound Transit commuter rail ridership increased by 5 to 10%
- West Seattle water taxi ridership increased 135%, Vashon passenger ferry service increased by 27%
- Longer travel times for King County Metro buses rerouted off SR 99
- More cyclists on the road to avoid congestion

Finding a new normal in ongoing changes

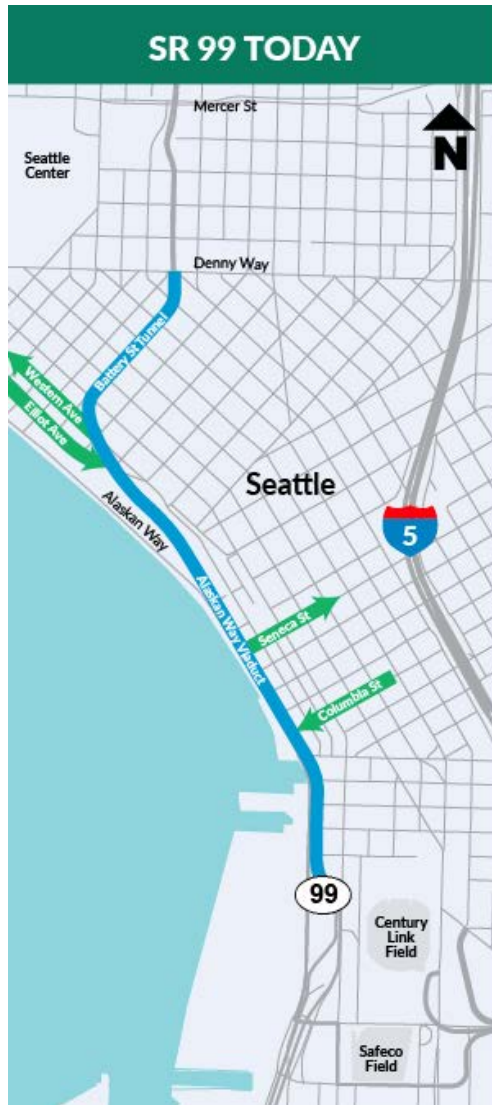

Opening the new SR 99 tunnel is just the start:

- Tunnel will open toll-free for a period of time.
- Traffic patterns will change because we are changing access to SR 99.
- Construction continues after the tunnel opens to drivers.

Seattle will experience ongoing change:

- It will take time before traffic patterns settle out.
- Tolls range from \$1 to \$2.25 with a *Good To Go* pass.
- Some trips will be quicker and others will be longer.
- The City will rebuild the new Alaskan Way, which will open in 2021.

New SR 99 ramps at the north portal – Looking north

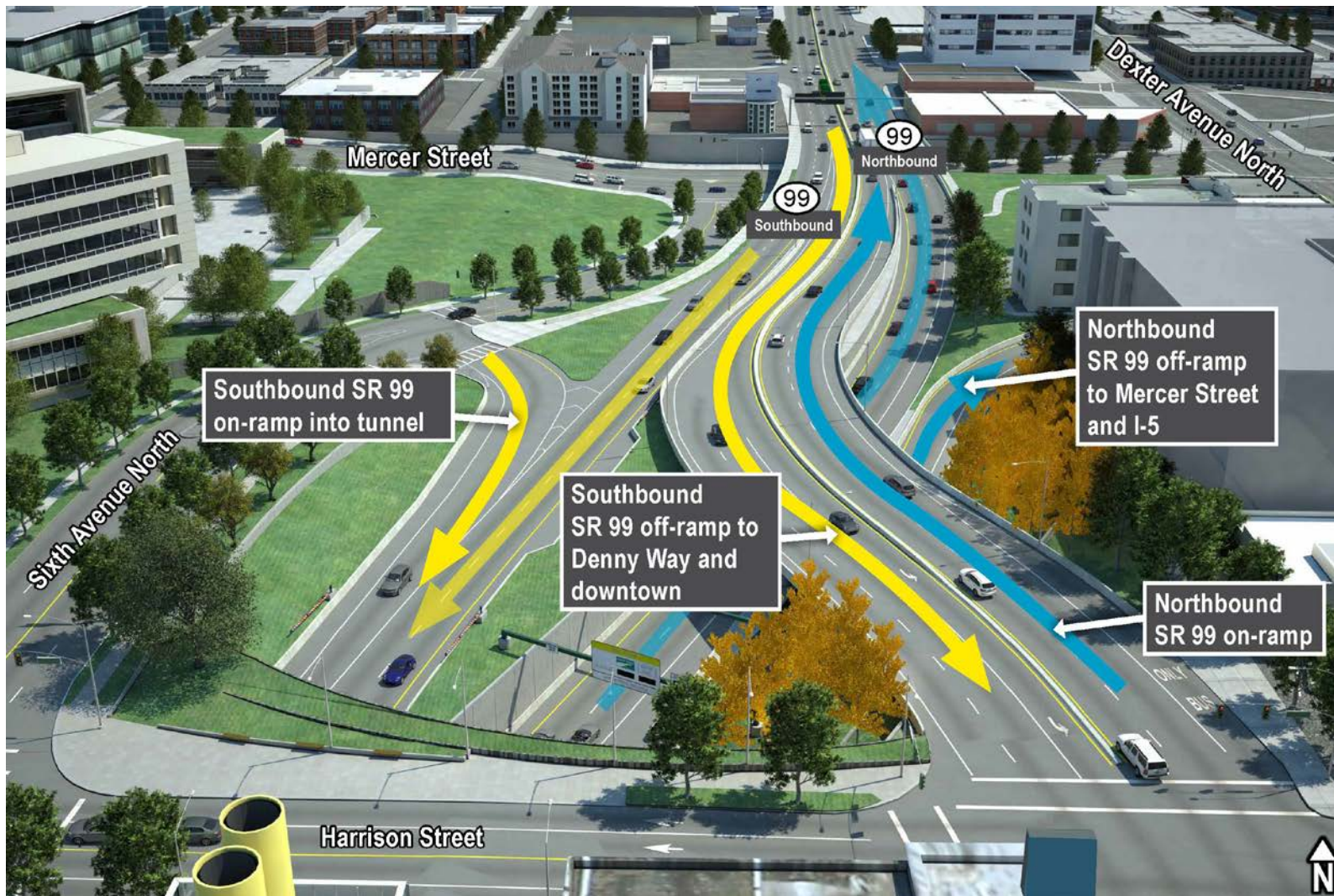

Opening the tunnel: Ramps at the south portal

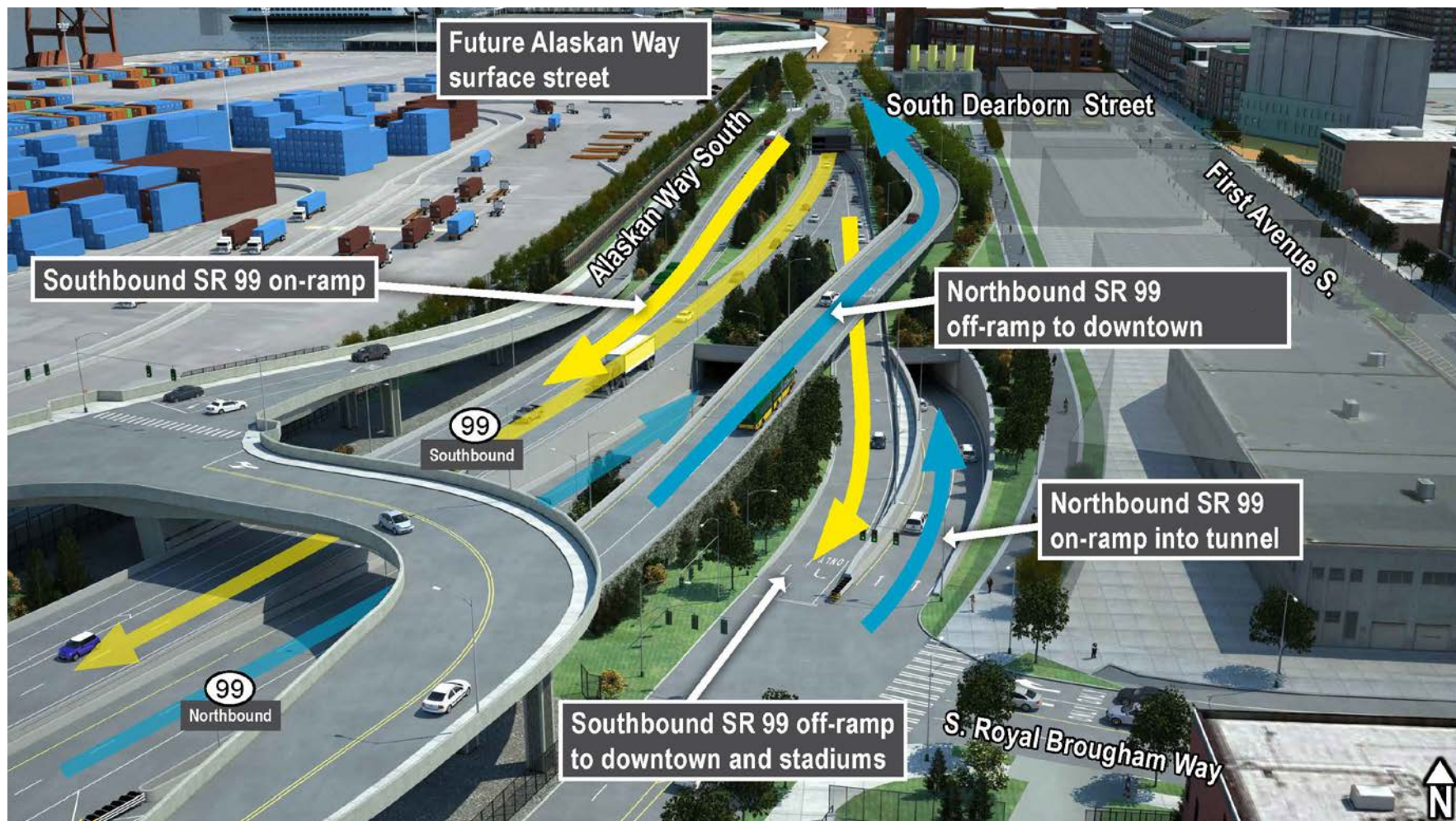

Construction after the SR 99 tunnel opens



Viaduct removal: Approx. 6 months

Battery Street Tunnel decommissioning:
Approx. 24 months

North surface street connections: Approx.
15 months

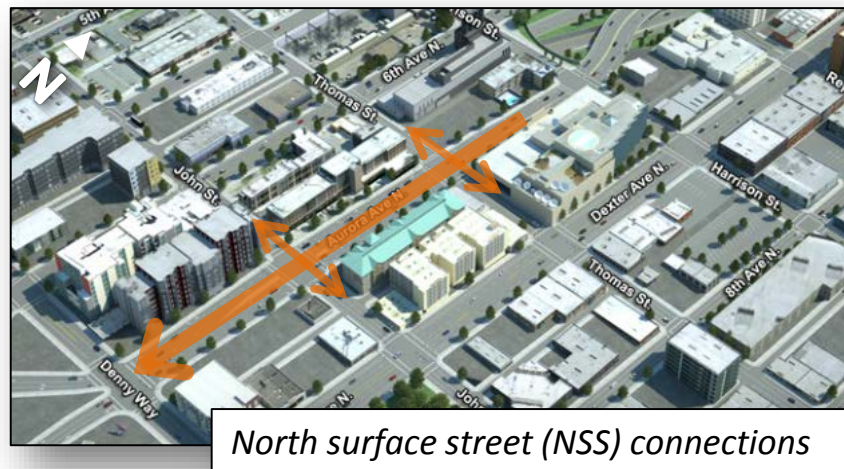



Responding to the SR 99 closure



Staff Transportation Operations Center 24/7 and deploy police at key transit intersections



Extend transit priority hours on 3rd Avenue to 6AM to 7PM, add bus trips on key Metro routes, and support Metro's additional Water Taxi service



Modify and schedule permitted construction work for maximum travel capacity



Work with downtown Seattle employers to provide SR 99 consultations and support through Commute Seattle



Launch www.seattle.gov/traffic with corridor specific travel information to help plan your trips





We're entering a new normal



Preparing for Seattle Transit Tunnel being for Light Rail ONLY in March 2019



Share real-time construction and traffic information with web map providers



Add off-board fare payment on 3rd Ave for quicker boarding and build a new transit path on 5th and 6th Avenues



Limit SDOT construction and maintenance work downtown



Expand Ride2 Service to SE Seattle; Encourage and support ORCA LIFT sales



Continue public engagement and awareness





What you can do to plan and prepare

We Need Your Help

- How can we reduce drive-alone trips during the most congested times?
- How can you help us prepare the region for traffic and travel changes to and through downtown Seattle?
- How can we work together to inform your members?

How you can prepare

- Stay informed
- Whenever possible, don't drive alone
- Be flexible and creative
- Leave extra time
- Share information with your networks
- Sign up for alerts at www.seattle.gov/traffic
- Research commute options at www.kingcounty.gov/getready





Questions?

How to REACH SDOT

Know Before You Go:

www.seattle.gov/traffic

Twitter:

@seattledot

@SDOTtraffic

Metro Trip Planning Resources:

<https://kingcounty.gov/getready>

How to REACH WSDOT

WSDOT Live Traffic Cameras:

www.wsdot.com/traffic/seattle/default.aspx

WSDOT Travel Times:

www.wsdot.com/traffic/traveltimes/default.aspx

Twitter:

@BerthaDigsSR99

#Realign99

Email:

viaduct@wsdot.wa.gov

www.99tunnel.com | www.AlaskanWayViaduct.org